

RAILMOUNTS

StarPort RailMounts bring the versatility and ease of the StarPort range to your vessel's rails.

To get the best possible use out of your StarPort RailMount, please ensure:

1. Installation doesn't compromise the use of emergency equipment and doorways
2. While the RailMount holds the rail firmly, a length of grip tape for extra grip is also supplied (recommended when using with Rod Holders). Peel off the adhesive cover and stick the grip tape on the rail location before mounting.
3. NOTE: The StarPort collar is NOT used for the RailMount
4. NOTE: Ensure nuts are firmly pressed into the recesses so they don't fall out whilst threading the bolts

19-25mm Installation

RailMount 19-25

- 1) Assemble the RailMount as shown and if using grip tape leave for 12 hours before applying full load.
- 2) Because rails come in different diameters, the RailMount 19-25 comes with plastic and rubber inserts. Plastic insert is used for 19mm rails only.

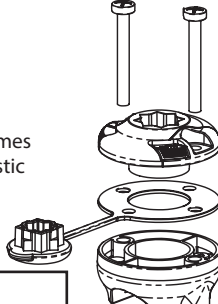

RailMount 32-41

The RailMount 32-41 is used for rails from 32-41mm (1.25-1.6 in) rails, round or square. Mounting to rails is very similar to the RailMount 19-25 (above), with these additions:

- 1) To fit a 32mm round rail: Use NO spacers; both rubber inserts and grip tape optional.
- 2) To fit a 32mm square rail: Use ONE spacer pair and one rubber insert.
- 3) To fit a 41mm round rail: Use TWO spacer pairs, both rubber inserts, grip tape optional.

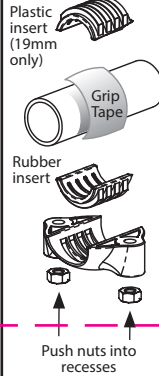

41mm Round Rail Installation

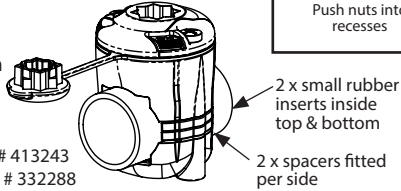

NZ Reg Des # 413243
Aus Reg Des # 332288
US Reg Des Pat # D658,482

32mm Round Rail Installation

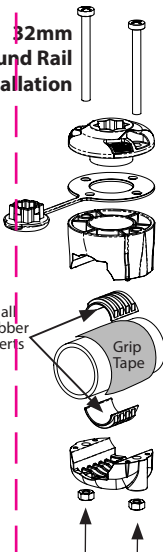

32mm Square Rail Installation

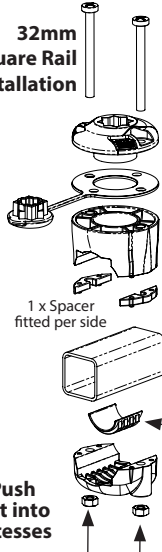

Hobie H Rail Installation

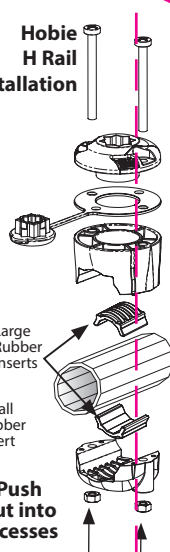

Note:

We strongly recommend that you tether your fishing rod to the boat while in use. Loss of fishing rods while using the RAILBLAZA RodHolder is not covered by warranty.

Note:
Please do not use Petroleum based lubricants on the StarPort slide. Silicone based products are best suited. (Please check can contents before using).